

Pica Cube™ 4C & 4CA

DESIGNED BY THE BLACK TANK



Gorgeous Palette of Colors

Pica Cube 4C and 4CA fixtures pack an unprecedented 22-24 watts of output into just a 2.5 inch cube! The fixture is built on Black Tank's GEN2 controls and patented heat management technology which provides users amazing light quality and options for broad-ranging installations for archtainment, retail, museum, cruise ship and architectural applications.

The best-in-class quad-chip emitters inside the Pica Cube RGBW 4C and the RGBA 4CA produce a gorgeous palette of saturated, mid-tone and pale tint colors. Thanks to the high quality of the emitters, the 4C and 4CA can also mix an attractive, full spectrum white light in warm and cool color temperatures - not the unflattering compromise found in other color-mixing LED lights.

The Pica Cube 4CA features a unique, phosphor-converted amber emitter – not found in any other RGBA fixture this size. This enables it to produce an expanded palette of saturated colors and rich, warm-tones of full-spectrum white light.

The Pica Cube can be powered via AC Mains (100-240VAC) using an available power-supply and controlled using standard DMX or in standalone mode via its easy-to-use on-board controls. The optional Pica Portal™ is capable of powering and controlling up to four Pica Cubes by providing power and data through a common Cat5 (24 AWG) cable.



WHAT'S IN THE BOX

Pica Cube

Set of Symmetrical Spread Lenses

Requires Wall Adapter or Pica Portal for power, each sold separately.

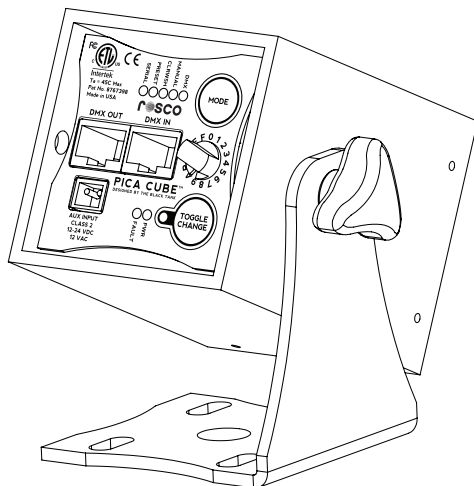

KEY FEATURES

- RGBW 4C and the RGBA 4CA produce a broad palette of different hues, as well as an attractive, full spectrum white light in warm and cool color temperatures
- 4C & 4CA single chip optic with homogenizing lens features superb color uniformity and fringe-free shadows
- Unique patented (US Patent No. 8,767,398) heat management system packs the most lumens into the smallest form factor
- Variable power input from 12-24VDC enables versatile power options
- Over 90 luminaires on a single 20A circuit
- Flicker-free dimming in 8 or 16 bit resolution
- Intuitive on-board controls
- Easily installed in many applications using CAT5 cable that carries Power + Data
- Full assortment of spot, medium and wide lenses included
- Novel "filament mode" mimics the delayed blackout glow of incandescent fixtures

Pica Cube™ 4C & 4CA

DESIGNED BY THE BLACK TANK



SPECIFICATIONS

Input Voltage:	12-24VDC or 12VAC	Humidity:	0 - 95% non-condensing
Power Consumption:	22W (DC Input) or 24W (AC Input) at 100% Output	Dimensions:	2.5 in x 2.5 in x 3.6 in (63.5 mm x 63.5 mm x 91 mm)
Power Input:	Power Adapter (100-240VAC In/12-24VDC Out) or CAT5 (Power +Data)	Weight:	0.9 lbs (0.41 kg)
LED:	1 x 12W Osram Multi-chip	Housing:	Powder Coated Aluminum Extrusion (1/8" wall)
Lumen Maintenance:	80,000 hours B50 L70 at 45° C (LM-79-08 Standard)	Approvals:	FCC Class A Radiated and Conducted ETL / UL Standards 1573 and 8750 cETL / CSA C22.2 #166-M1983 CE / IP20 Rated
Data:	DMX, RJ45 Connectors		
Output:	4C: 285 lumens 4CA: 270 lumens		
Color Range:	4C: Red/Green/Blue/White (6500K) 4CA: Red/Green/Blue/Amber		
Operation:	DMX: 8 or 16 bit DMX512/Manual: Rotary Knob		
Operating Temp.:	-13° to 113° F (-20° to 45° C)		



Pica Cube™ 4C & 4CA	
Item Code	Description
515 90200 1014	Pica Cube 4C - Black
515 90200 2014	Pica Cube 4C - White
515 90200 1040	Pica Cube 4CA - Black
515 90201 0150	Wall Power Adapter*
515 90201 0160	Pica Portal™ 125*

*not included with Pica Cube

Pica Cube™ Accessories			
Item Code	Description	Item Code	Description
515 91041 0006	Top Hat - Black	515 91010 0220	20° Symmetrical Spread Lens
515 91041 0005	Top Hat - White	515 91010 0240	40° Symmetrical Spread Lens
515 91041 0004	Egg Crate Louver - Black	515 91010 0260	60° Symmetrical Spread Lens
515 91041 0003	Egg Crate Louver - White	515 91010 0005	Set of Three Symmetrical Spread Lenses
515 91041 0002	Barn Doors - Black	515 91013 3005	30° x 5° Asymmetrical Spread Lens
515 91041 0001	Barn Doors - White	515 91013 6010	60° x 10° Asymmetrical Spread Lens
515 91110 0028	Pica Track Adapter - Black	515 91013 7545	75° x 45° Asymmetrical Spread Lens
515 91110 0029	Pica Track Adapter - White	515 91010 0006	Set of Three Asymmetrical Spread Lenses